

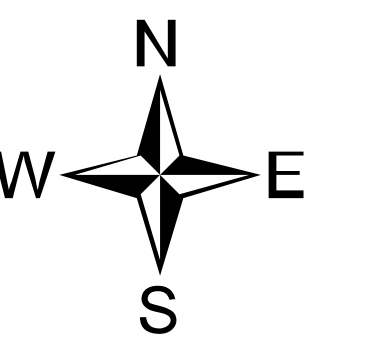

TOWN OF BAR HARBOR

HANCOCK CO. MAINE



LEGEND

- Parcel Boundary
- Right of Way
- Historical Parcel Line
- Stream
- Lake or Pond
- Building
- Match Line
- Zoning District Boundary
- Vernal Pools
- Wetlands
- 911 Property Address

FEMA DISTRICT

- A
- AE
- VE
- X

LOCATION

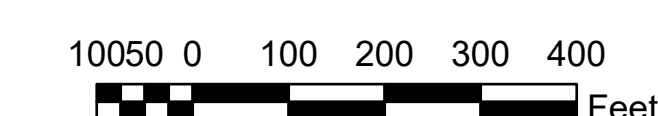
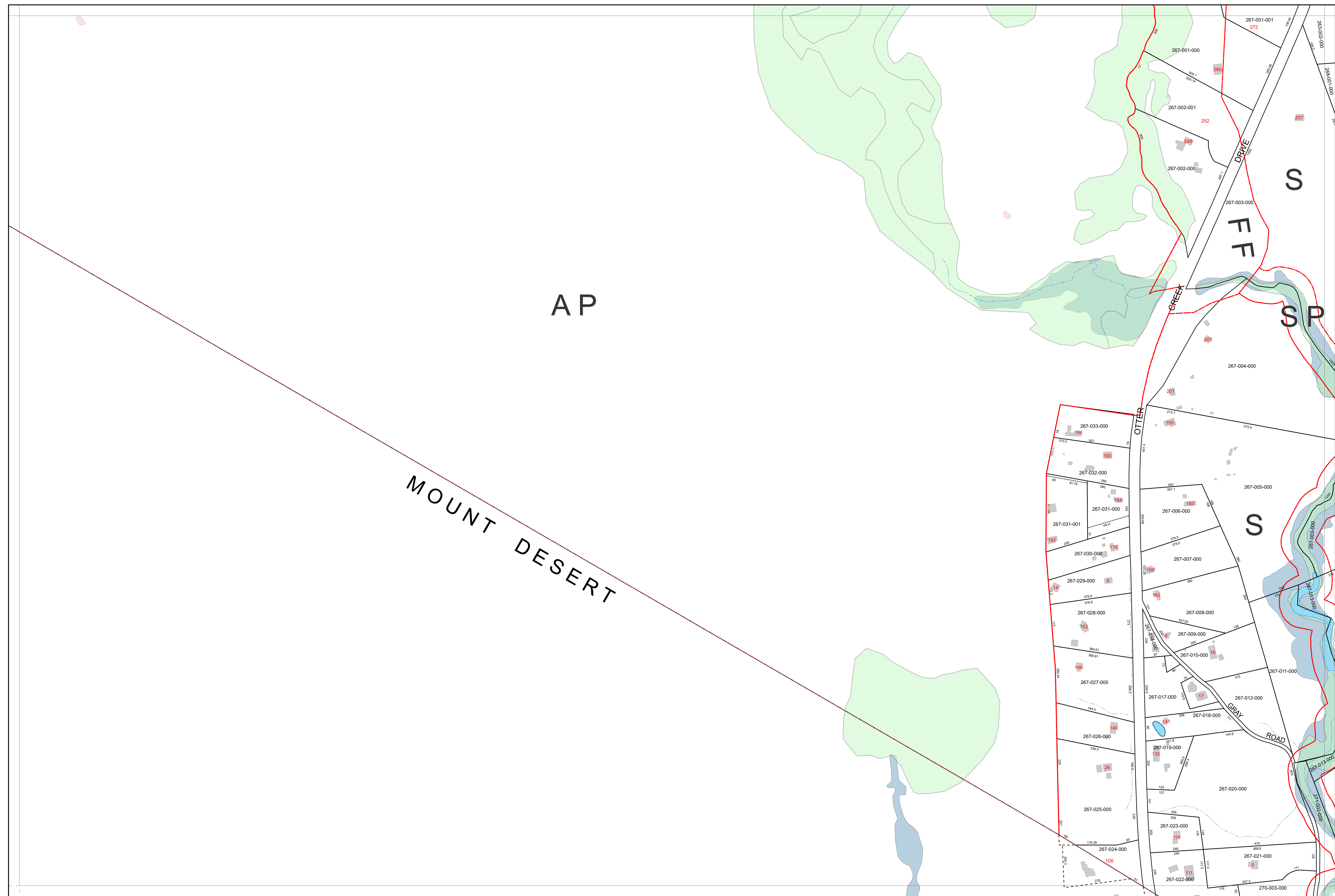
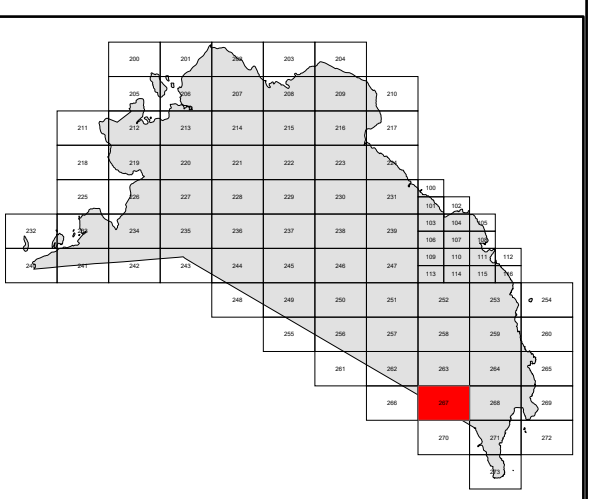
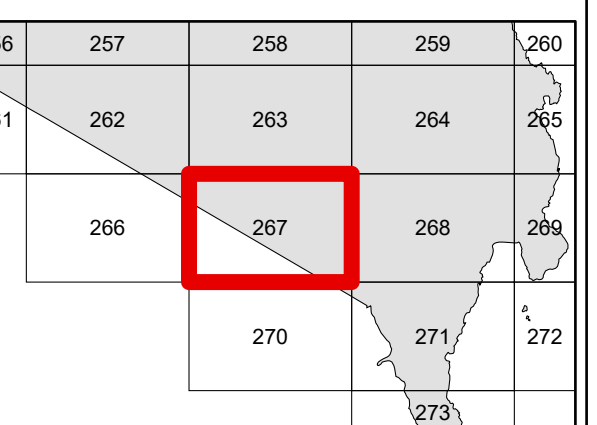

**Dirigo Spatial Systems, Inc.**  
 1030 Carmel Road North • Bangor, Maine 04444  
 www.dirigospatial.com • (207) 745-3906

**kappa mapping, inc.**  
 6 State Street, Suite 301  
 Bangor, Maine 04401  
 (207) 942-5200

**DISCLAIMER**  
 Tax maps are compiled from aerial photography, existing surveys, deeds, and landowner's descriptions. They are to be used for assessment purposes only, and not for conveyance.

Effective 4/1/2021

2021  
267